



# RevoSurface® Pick A Design

## Strap

There are 3 strap configurations to choose from:

### 1 Simple Straps

For volume adjustments and simple donn/doff.

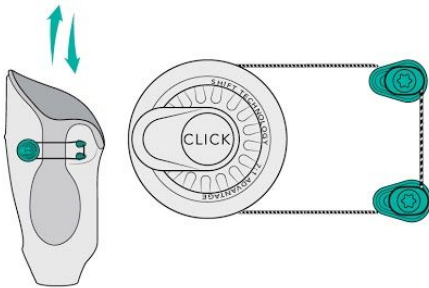

### 2 Releasing Straps

For fully opening.

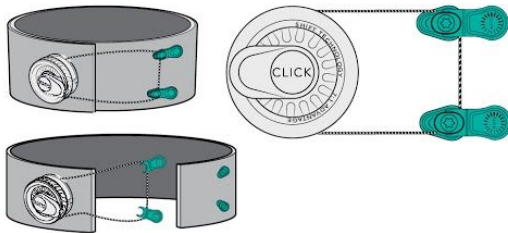

### 3 Dynamic Straps

For fitting conical shapes or closing a larger device.

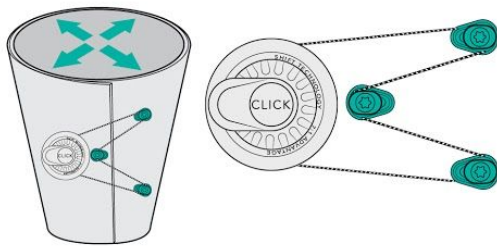

Dynamic strap can also be made with releasing guides to fully open.

## Lacer

There are 2 lacer configurations to choose from:

### 1 Fixed Lacer

For easily slipping on/off the body.

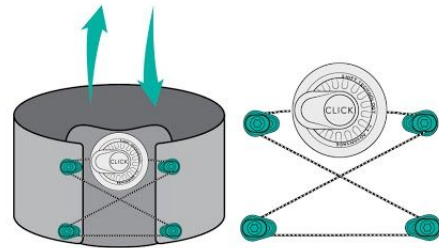

### 2 Releasing Lacer

For fully opening a device.

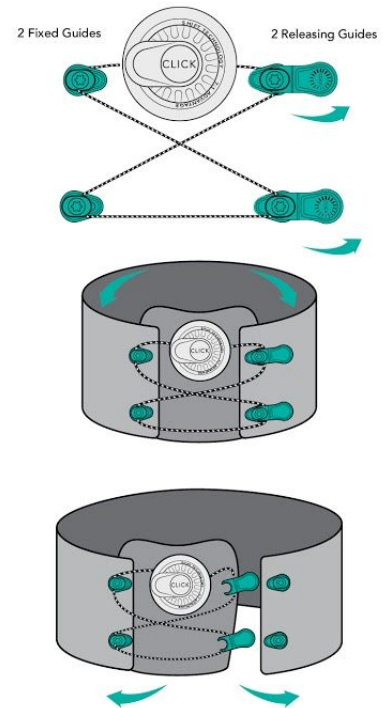



# Planning Your Configuration

- 1 For all designs, first determine the trim lines of the device and sketch on device.
- 2 Next, determine where you want to place the Click® Reel:
  - a. Make sure it is in line with your likely lace path.
  - b. Ensure that the reel will be easily accessible by the patient.
  - c. Place the Click® Reel so it will not protrude and catch on clothing or edges.
- 3 Plan the lacing configuration:
  - a. Determine likely lace guide placements and mark their location on the device.
  - b. Optimize the lace angles.
  - c. Pair guides where possible to span larger areas.

### For the Dynamic Strap:

Place the middle guide close to the reel to create optimal lace angles.

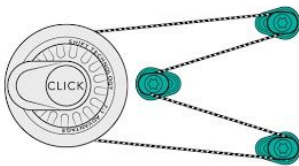

### For the Simple Strap:

Parallel laces are best.



Place guides such that the lace angles are as minimal as possible to create optimum closure force.

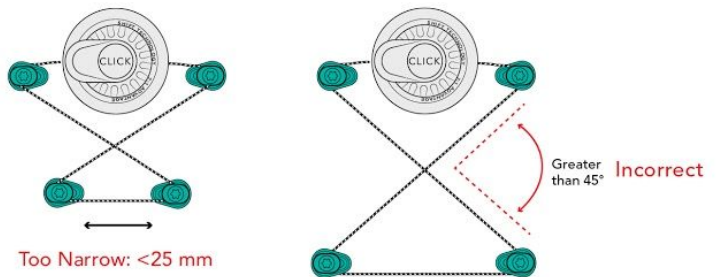
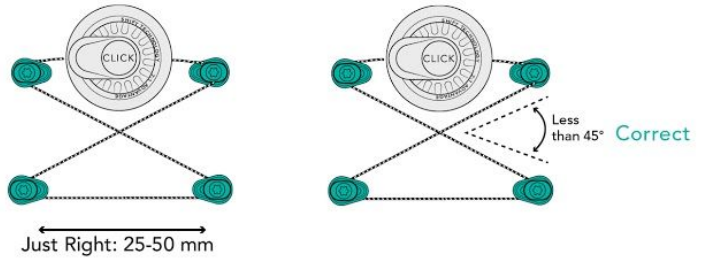

Single guides create closure over a smaller area.

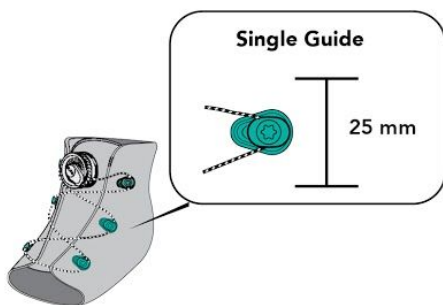

Paired guides span larger distances.

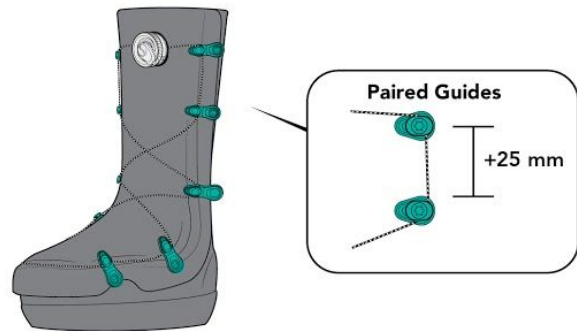

! Plan your configuration well before starting to mount components!  
It will save you time later.